

RAINBOW ROOM

65TH FLOOR CAPACITY

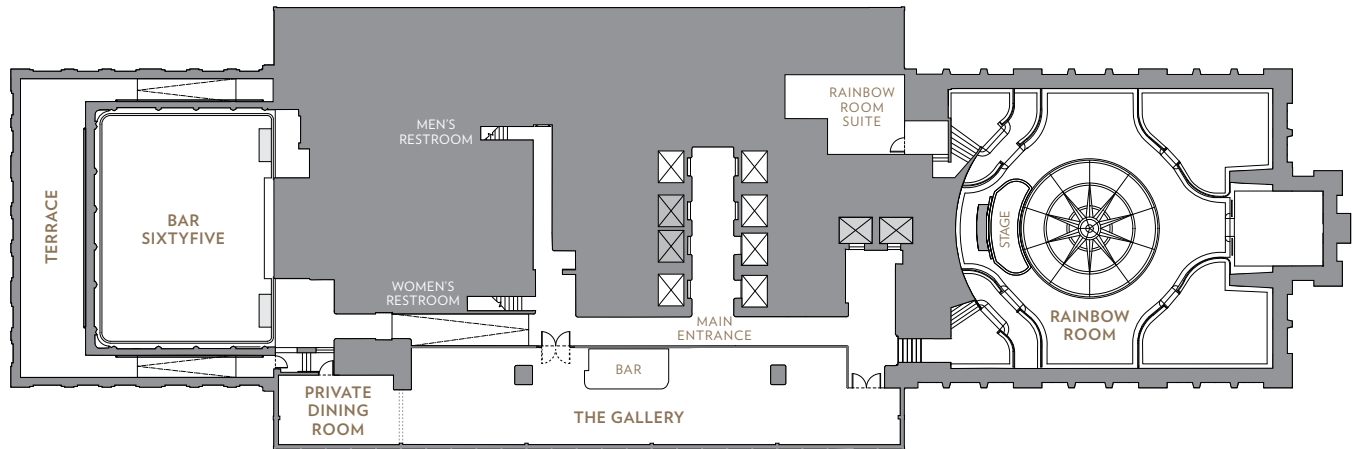

Rainbow Room The Gallery Bar SixtyFive	Capacity	The Gallery	Capacity
Full Floor Exclusivity Reception	500	Reception & Sit Down Dinner	60
Rainbow Room The Gallery		Bar SixtyFive	
Reception	400	Reception	190
Reception & Sit Down Dinner	300	Seated Dinner	130
Reception & Dinner with Dancing	250		
Rainbow Room		Outdoor Terrace	
Theater Style	300	Reception	85
Classroom Style (3 per 6')	225		
Crescent Style	180	Private Dining Room	
Classroom Style (2 per 6')	150	Reception	25
		Seated Dinner (2 rounds)	24
		Seated Dinner (1 rectangular table)	12

SPACE	SQ FT	DIMENSIONS	CEILING
Rainbow Room	4,464	72 x 62	18'
The Gallery	2,530	110 x 23	8'-6"
Private Dining Room	360	24 x 15	8'-6"
Bar SixtyFive	3,463	38 x 54	12'-3"
Outdoor Terrace	910	14 x 65	-